

Proposed Test Fit

PENANG ROAD

TOWER 2

TOWER 1

TOWER 2

2-TENANT

PENANG ROAD

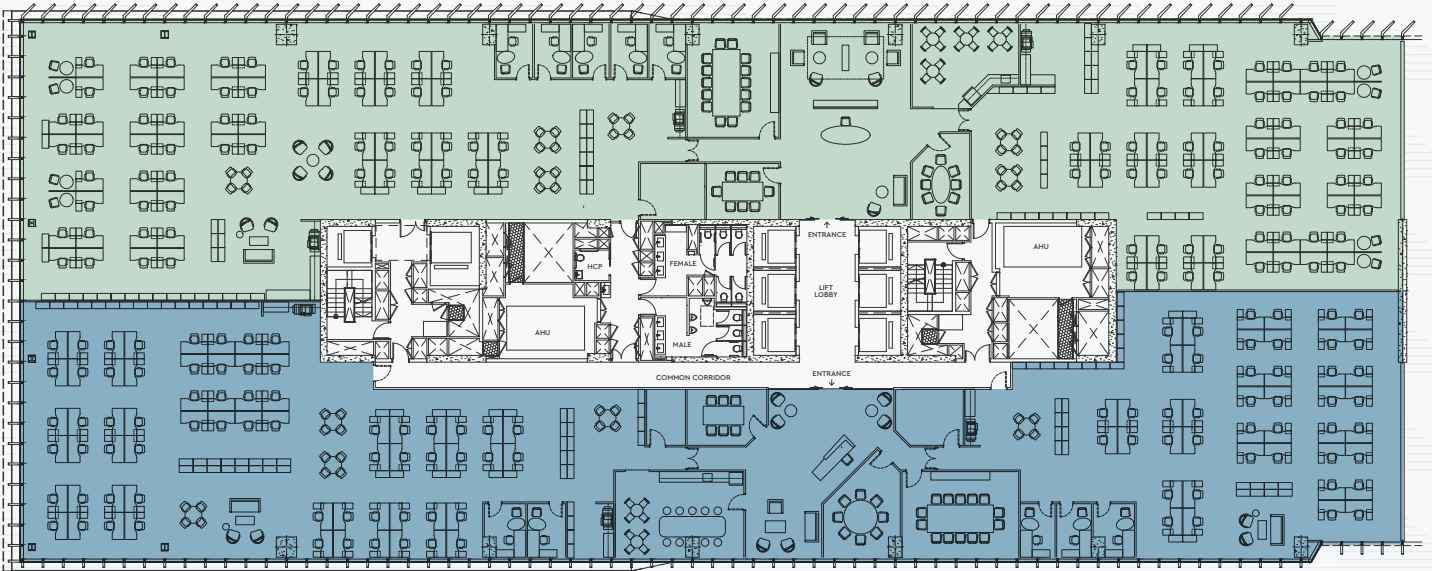

Approximate
Net Lettable Area

12,048 sqft
1,119 sqm

Tenant 1

Office	5
Work Stations	120
Meeting Rooms	3
Total Headcount	126
Density	8.9 sqm/pax

Approximate
Net Lettable Area

11,159 sqft
1,037 sqm

Tenant 2

Office	5
Work Stations	108
Meeting Rooms	3
Total Headcount	114
Density	9.1 sqm/pax